

REGOLATORI DI PORTATA / FLOW-RATE REGULATORS

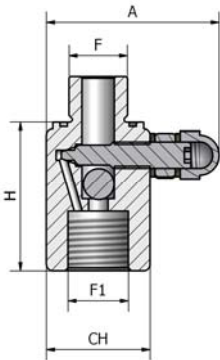

Modello	Pressione Max	Portata Max senza Accumulatore	Portata Max con Accumulatore	F Lato Accumulatore	F1 Lato Impianto	H	A	Esagono	Peso
Model	Max Pressure	Max Flow without Accumulator	Max Flow with Accumulator	F Accumulator's Side	F1 Installation's Side	H	A	Hexagon	Weight
	Bar	Lt/min				mm	mm	mm	Kg
VSA 18	330	50	Aumenta seguendo una funzione direttamente proporzionale al valore della precarica di azoto / increases following a function directly proportional to the value of the nitrogen precharge	M 18x1.5	M 18x1.5	45	53	32	0.3
VSA 21	330	50		M 18x1.5	½" BSP	45	53	32	0.3
VSA 34	330	90		¾" BSP	¾" BSP	57	65	36	0.45

RIDUZIONI / ADAPTERS

Disegno / Drawing 1

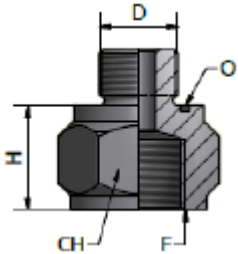

Disegno / Drawing 2

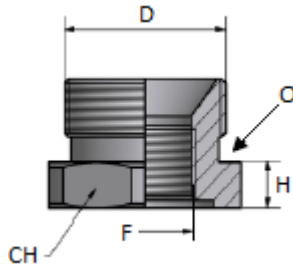

Modello	D	F	O	H	Esagono	Disegno
Model	D	F	O	H	Hexagon	Drawing
					mm	
VS21	M18x1.5-M	½" BSP-F	OR2081	24	32	1
VS34	1-¼" BSP-M	¾" BSP-F	OR3150	11	50	2
VS210	2" BSP-M	1" BSP-F	OR3218	11	70	2
VS212	2" BSP-M	½" BSP-F	OR3218	11	70	2
VS214	2" BSP-M	1-¼" BSP-F	OR3218	11	70	2
VS211-2	2" BSP-M	1-½" BSP-F	OR3218	11	70	2
VS234	2" BSP-M	¾" BSP-F	OR3218	11	70	2
VS238	2" BSP-M	⅜" BSP-F	OR3218	11	70	2

Esecuzioni speciali a richiesta / Special execution on request

RIDUZIONI SPECIALI / SPECIAL ADAPTER

Disegno / Drawing 1

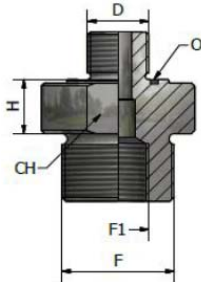

Disegno / Drawing 2

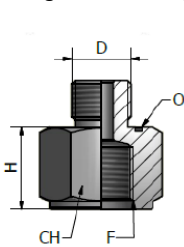

Modello	D	F	F1	O	H	Esagono	Disegno
Model	D	F	F1	O	H	Hexagon	Drawing
					mm	mm	
VS18/M33-12	M18x1.5-M	M33x1.5-M	½" BSP-F	OR2081	16	41	1
VS18/M33-18	M18x1.5-M	M33x1.5-M	M18x1.5-F	OR2081	16	41	1
VS18/SAE8	M18x1.5-M	1-1/16"-8 UNF	///	OR2081	25	32	2
VS18/SAE12	M18x1.5-M	1-1/16"-12 UNF	///	OR2081	25	46	2

Esecuzioni speciali a richiesta / Special execution on request

NIPPLI / NIPPLES

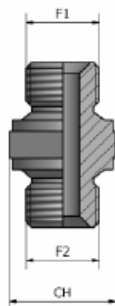

Tipo	F1	F2	Esagono
Type	F1	F2	Hexagon
			mm
NS15	M18x1.5	⅜" BSP	27
NS21	M18x1.5	½" BSP	27

Esecuzioni speciali a richiesta / Special execution on request